

# 3 SPEED - FWD 2WD, 4WD

# SUBARU - M41, M41A GUNMA

**673** Turbine Shaft

**671** Pump Shaft

**594** Ring Gear

**251** **058** Planet

**584** Planet

**058** **652** **246** **052** **612** Forward Sun Gear

**241** **056** **614** Rev. Sun Gear

**885** **154** **114** **134** **857** Low/Rev. Clutch

**140** **108** **128** **855** Forward Clutch

**564** **877** **984** **974** **964** **554** Forward Drum

**876** **140**

**036** **181** **179** Stator w/Gears

**511** **520** **530** Pump & Rear Cover

**284** **283** **282** **712** **285** **287**

**675** **880** **286** **711** **710** - 4WD Only -

**433** **770** **066** **074** **271** **437** - 4WD Only -

**433** **010** **011** **300** **839** **765** H

Deluxe Kit	008
Compliance Kit	007
Master Kit	006
Less Steel Kit	004
Overhaul Kit	002
Bushing Kit	030
Washer Kit	200
Bearing Kit	201
Technical Manual	400
Pump Part	507
Valve Body Parts	741
Case Parts	761

Note: Not all items are available for all transmissions

# SUBARU - M41, M41A GUNMA

# 3 SPEED - FWD 2WD, 4WD

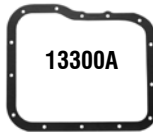
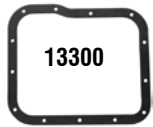

53010

**1975-Up**  
Model 1600DL, 1800  
Station Wagon -  
4D-GL, 3D-GL, 4D-4WD

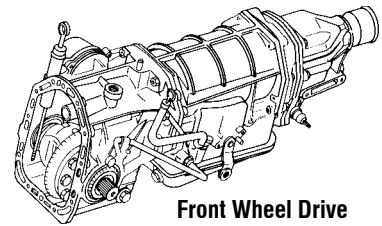

Front Wheel Drive

ILL.	DESCRIPTION	QTY.	YEAR	PART NO.	REFERENCE NO.
<b>MASTER OVERHAUL KITS (WITH STEELS)</b>					
006H	M41 w/o Transfer Plates .....	1	75-82	13006F	K5200
006H	M41 w/o Transfer Plates .....	1	83-84	13006ABF	K5200A
006H	M41 w/o Transfer Plates .....	1	85-94	13006BF	K5200B
<b>LESS STEEL KITS</b>					
004H	M41 w/o Transfer Plates .....	1	75-82	13004F	K5200-LS
004H	M41 w/o Transfer Plates .....	1	83-84	13004ABF	K5200A-LS
004H	M41 w/o Transfer Plates .....	1	85-94	13004BF	K5200B-LS
<b>OVERHAUL KITS (W/ RINGS &amp; SEALS)</b>					
002H	M41.....	1	75-82	13002F	K52900
002H	M41.....	1	83-94	13002AF	K52900A
<b>GASKET &amp; SEAL KITS (W/O RINGS &amp; SEALS)</b>					
000H	M41.....	1	75-94	13000F	K52900A-1
<b>FILTER KITS</b>					
011H	M41 (Combo w/ all 3 Pan Gaskets) .....	1	75-94	13011C	FK52800
<b>FILTERS</b>					
010H	M41.....	1	75-94	53010	45800
<b>BANDS</b>					
<b>Prefix Key: B = Borg Warner, A = OEM (Exc. BW), N = All Other New, R = Relined</b>					
022C	Intermediate.....	1	75-94	13022	65700
<b>BUSHINGS</b>					
030H	Bushing Kit .....	1	75-94	13030	K52901
<b>METAL CLAD SEALS</b>					
070A	Front.....	1	75-94	13070	N/A
074H	Rear (Extension Housing) 4wd .....	1	75-94	13074	52201
076A	Right Axle (2" OD) Turbo 4wd .....	1	75-94	13076A	52205
077A	Left Axle (2" OD) Turbo 4wd.....	1	75-94	13077A	52206
078	Speed-O Shaft .....	1	75-94	13078	52202
079	Governor to Case .....	1	75-94	13079	52204
<b>FRICTION PLATES</b>					
106	Direct & Forward.....	6-8	75-94	53100	45103
114E	Low & Reverse (.092") (51 T).....	3-4	75-82	13114	52102
114E	Low & Reverse (.095") (45 T).....	4-5	83-84	13114A	52102A
114E	Low & Reverse (.091") (48 T).....	5	85-94	13114C	52102B
118D	Transfer Case.....	3-4	83-94	13118	52106



# SUBARU R4AX-EL (4EAT) 4 SPEED - 2WD & 4WD

# FWD 1ST & 2ND DESIGN

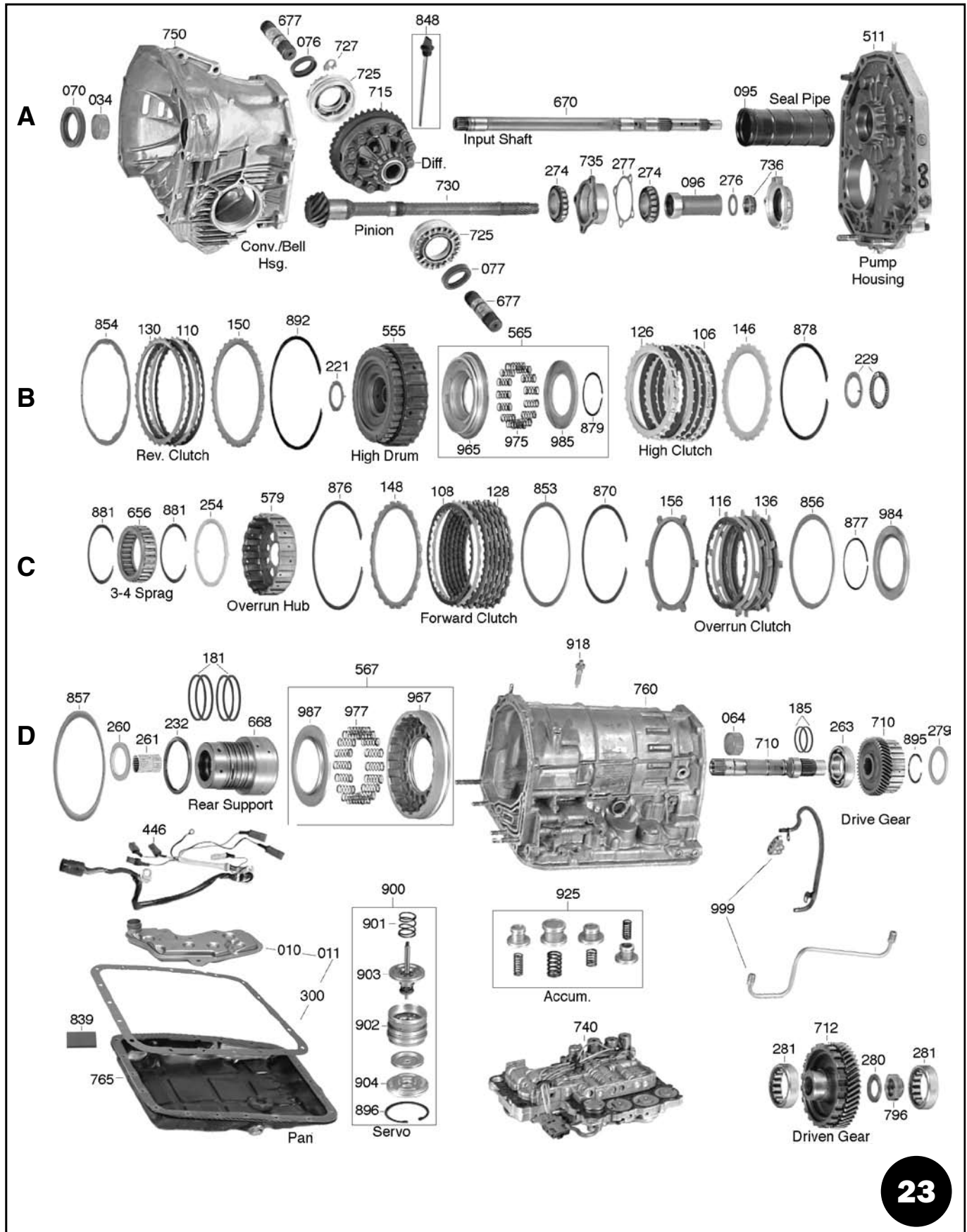

# FWD 1ST & 2ND DESIGN

# SUBARU R4AX-EL(4EAT) 4 SPEED - 2WD & 4WD

**E**

671  
531  
520  
180  
179  
020  
211  
220  
046  
556  
566  
966  
976  
986  
893

Pump Rotor Set  
Stator  
Reverse Drum

**F**

583  
575  
049  
049  
241  
622  
052  
244  
582  
883  
238  
614  
247  
584  
251  
060  
594  
254  
574

High Hub  
Shell w/Sun Gear  
Front Planet  
Rear Sun Gear  
Rear Planet  
Rear Ring Gear  
Forward Hub

**G**

974  
969  
964  
048  
554  
235  
890  
658  
286  
890  
885  
154  
134  
114

Forward Drum  
Low/Rev. Clutch

**H**

268  
873  
158  
118  
138  
568  
879  
978  
968  
675  
184  
271  
436  
999  
770  
066  
074  
432  
410  
991  
995

Transfer Clutch  
Output Shaft (transfer case)  
Extension Hsg.

Deluxe Kit	008
Compliance Kit	007
Master Kit	006
Less Steel Kit	004
Overhaul Kit	002
Bushing Kit	030
Washer Kit	200
Bearing Kit	201
Technical Manual	400
Pump Part	507
Valve Body Parts	741
Case Parts	761

Note: Not all items are available for all transmissions

# SUBARU R4AX-EL (4EAT) 4 SPEED - 2WD & 4WD

# FWD 1ST & 2ND DESIGN



**23010**  
(1/8" Tall Neck)



**23010A**  
(1/2" Tall Neck)

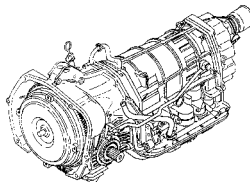

The Subaru 4 Speed Automatic Transaxle w/L/U and Overdrive used in both 2WD & 4WD models, 1st and 2nd Design Transmissions.



**23010B**

ILL.	DESCRIPTION	QTY.	YEAR	PART NO.	REFERENCE NO.
<b>MASTER OVERHAUL KITS (WITH STEELS) (1)</b>					
006H	All 1987-5/95 (Exc. Legacy, Legacy Turbo, Impreza & SVX).....	1	87-95	23006F	K7700
006H	All 6/1995-98 (Exc. Legacy, Legacy Turbo, Impreza & SVX).....	1	95-98	23006DF	K7700D
006H	Legacy (Turbo).....	1	90-94	23006BF	K7700A
006H	Legacy (1/90-92 Also Sell 5-23118A, 5-23138A) .....	1	87-92	23006F	K7700
006H	Legacy (93-5/95).....	1	93-95	23006CF	K7700B
006H	Legacy (6/95-98) (2.5L DOHC).....	1	95-98	23006DF	K7700D
006H	Impreza.....	1	93-97	23006CF	K7700B
006H	SVX (1/95-97 Also Sell 6-73108A, 6-73128) .....	1	92-97	23006BF	K7700A
006H	All 1999-Up (Spin On Filter).....	1	99-Up	23006EF	K7700F
<b>LESS STEEL KITS (1)</b>					
004H	All 1987-5/95 (Exc. Legacy, Legacy Turbo, Impreza & SVX).....	1	87-95	23004F	K7700-LS
004H	All 6/1995-98 (Exc. Legacy, Legacy Turbo, Impreza & SVX).....	1	95-98	23004DF	K7700D-LS
004H	Legacy (Turbo).....	1	90-94	23004BF	K7700A-LS
004H	Legacy (1/90-92 Also Sell 5-23118A) .....	1	87-92	23004F	K7700-LS
004H	Legacy (93-5/95).....	1	93-95	23004CF	K7700B-LS
004H	Legacy (6/95-98) (2.5L DOHC).....	1	95-98	23004DF	K7700D-LS
004H	Impreza.....	1	93-97	23004CF	K7700B-LS
004H	SVX (1/95-97 Also Sell 6-73108A).....	1	92-97	23004BF	K7700A-LS
004H	All 1999-Up (Spin On Filter).....	1	99-Up	23004EF	K7700F-LS
	<i>(1) Kits Include Transfer Frictions</i>				
<b>OVERHAUL KITS (W/ RINGS &amp; SEALS)</b>					
002H	All 87-98 .....	1	87-98	23002F	K77900
002H	All 99-Up .....	1	99-Up	23002AF	K77900B
<b>FILTER KITS</b>					
011D	1/8" Pick-up Tube .....	1	87-91	23011	FK77800
011D	1/2" Pick-up Tube .....	1	90-98	23011A	FK77800A
011D	All (99-Up).....	1	99-Up	23011B	FK77800B
<b>FILTERS</b>					
010D	1/8" Pick-up Tube .....	1	87-91	23010	77800
010D	1/2" Pick-up Tube .....	1	91-98	23010A	77800A
010D	All (99-Up).....	1	99-Up	23010B	77800B
013	Filter (Spin-On).....	1	99-Up	23013	77801
<b>BANDS</b>					
<b>Prefix Key: B = Borg Warner, A = OEM (Exc. BW), N = All Other New, R = Relined</b>					
020E	Overdrive .....	1	87-Up	73020	78700

# FWD 1ST & 2ND DESIGN

# SUBARU R4AX-EL(4EAT) 4 SPEED - 2WD & 4WD

ILL.	DESCRIPTION	QTY.	YEAR	PART NO.	REFERENCE NO.
<b>BUSHINGS</b>					
030H	Bushing Kit .....	1	87-98	23030	K77901
034A	Converter Housing (To Converter Hub) .....	1	87-Up	23031	77001
062	Output Shaft.....	1	87-Up	23062	77010
<b>METAL CLAD SEALS</b>					
070A	Front.....	1	87-Up	23070A	77203
072	Linkage.....	1	87-Up	23072	77208
074H	Rear (4wd Extension Housing) .....	1	87-Up	53074	45201
076	Axle, Right .....	1	87-Up	13076A	77205
077	Axle, Left .....	1	87-Up	13077A	77206
095A	Front Pump Oil Pipe.....	1	87-Up	23095	77210
096A	Pinion .....	2	87-Up	23096	77204
<b>FRICTION PLATES</b>					
104	2-4 Brake.....	3	99-Up	23104	77110F
106B	High (30 T) .....	4-5	87-98	93106B	68103B
106B	High (36 T) .....	5	99-Up	23106	77103F
108C	Low .....	6	99-Up	23108	77104F
108C	Forward (.063") .....	5	96-Up	73108A	78104
108C	Forward (.079") .....	5-6	87-95	73108	78104A
110B	Reverse (.079") (34 T) Tan.....	2	87-91	93110A	68100A
110B	Reverse (.079") (30 T) Green .....	2	92-96	73110AA	78100A
110B	Reverse (.079") (38 T) (3/97-98) .....	2	97-98	23110	77100B
110B	Reverse (.063") (30 T) .....	2	99-Up	23110A	77100F
114G	Low/ Reverse (.079").....	6	87-94	73114	78108
114G	Low/ Reverse (.063").....	7-8	89-Up	23114A	78108D
114G	Low/ Reverse (.071").....	5-7	92-98	23114B	77108A
116C	Overrun .....	3	87-98	73116	78106
118H	Transfer Clutch (.079") (24 T) .....	5	87-93	23118	77112
118H	Transfer Clutch (.071") (24 T) .....	6	91-Up	23118A	77112A
118H	Transfer Clutch (.071") (50 T) (Non USA).....	6	01-Up	23118B	N/A
<b>STEEL PLATES</b>					
124	2-4 Brake.....	2	98-Up	23124	77111F
126B	High (.078") (8 T) .....	4	98-Up	23126E	77102F
126B	High (.078") (24 T) .....	1-5	97-98	23126C	77102C
126B	High (.078") (27T) .....	1-5	89-Up	93126BA	68102C
126B	High (.108") (27 T) .....	1-5	91-Up	23126B	77102
126B	High (.118") (24 T) .....	3	97-98	23126D	77102D
126B	High (.118") (27 T) .....	3	87-Up	93126B	68102A
128C	Low .....	5-6	98-Up	23128	77105F
128C	Forward (.071") .....	5	95-Up	73128	78105
128C	Forward (.078") .....	5-6	87-Up	73128A	78105A
130B	Reverse (.063") (32 T) .....	2	98-Up	23130	77101F
130B	Reverse (.078") (30 T) 5.050" ID .....	2	93-Up	73130B	78101A
130B	Reverse (.078") (30 T) 5.355" ID .....	2	87-Up	93130A	68101A
134G	Low/ Reverse (.078").....	6	87-Up	73134	78109
134G	Low/ Reverse (.051").....	AR	87-98	73134A	N/A
134G	Low/ Reverse (.071").....	6-8	91-Up	23134B	77109
134G	Low/ Reverse (.063").....	4-7	93-Up	23134C	77109A
136C	Overrun .....	3	87-Up	73136	78107
138H	Transfer Clutch (.071").....	5	87-Up	23138	77113
138H	Transfer Clutch (.063").....	4-6	91-Up	23138A	77113A

SUBARU 4 SPD.



# SUBARU R4AX-EL (4EAT) 4 SPEED - 2WD & 4WD

# FWD 1ST & 2ND DESIGN

ILL.	DESCRIPTION	QTY.	YEAR	PART NO.	REFERENCE NO.
<b>PRESSURE PLATES</b>					
Prefix Key: D = OEM, A = Aftermarket New, R = Remanufactured					
146B	High Clutch 3.6mm .....	1	87-Up	73146A	N/A
146B	High Clutch 4.0mm .....	1	87-Up	73146AB	N/A
<b>VALVE BODY RECALIBRATION KITS</b>					
165H	Shift Kit®, Nissan Mazda Subaru 4 Speed Electronic (Transgo®) .....	1	87-98	T73165A	K78908
<b>SEALING RINGS</b>					
175H	Ring Kit.....	1	87-Up	23175	N/A
<b>THRUST WASHERS</b>					
211E	Stator to Reverse Drum .028" .....	1	87-Up	93211	78400
211E	Stator to Reverse Drum .035" .....	1	87-Up	93211A	78400A
211E	Stator to Reverse Drum .043" .....	1	87-Up	93211B	78400B
211E	Stator to Reverse Drum .051" .....	1	87-Up	93211C	78400C
211E	Stator to Reverse Drum .067" .....	1	87-Up	93211E	78400D
211E	Stator to Reverse Drum .075" .....	1	87-Up	93211F	78400F
254C	Rear Planet Ring Gear to Clutch Hub.....	1	87-Up	73254	78401
260D	Bearing Races, Rear Hub to Rear Support .....	1	87-Up	73260A	78509A
<b>GASKETS &amp; O-RINGS</b>					
300D	Gasket, Bottom Pan (Cork) .....	1	87-98	23300	13615BX
300D	Gasket, Bottom Pan (Fiber).....	1	87-98	23300F	13615BF
300D	Gasket, Bottom Pan (Cork).....	1	99-Up	23300B	13615DX
300D	Gasket, Bottom Pan (Fiber).....	1	99-Up	23300BF	13615DF
<b>TECHNICAL MANUALS</b>					
400H	Tech Manual .....	1	87-98	23400	77Y01
400H	Tech Manual .....	1	99-Up	23400A	77Y02
<b>ELECTRICAL COMPONENTS</b>					
420	Solenoid Assembly (4 Solenoids) .....	1	87-98	23420	31A-180
420	Solenoid Assembly (7 Solenoids) .....	1	99-Up	23420B	31A-180B
421	Solenoid, #1 Shift (Green Connector) .....	1	99-Up	23421B	N/A
422	Solenoid, #2 Shift (Yellow Connector).....	1	99-Up	23422B	N/A
425	Solenoid, Lock-Up (TCC).....	1	87-98	23425	31A-180L
425	Solenoid, Lock-up (TCC) (Blue Connector) .....	1	99-Up	23425A	N/A
426	Solenoid, 2wd to 4wd (In Transfer Case) .....	1	87-98	23426	N/A
431	Solenoid, EPC (Red/ Pink Connector) .....	1	99-Up	23431A	N/A
432	Solenoid, 2-4 Brake Duty (Red/ Pink Connector).....	1	99-Up	23431A	N/A
432	Solenoid, 2-4 Brake Timing (Black Connector).....	1	99-Up	23432B	N/A
432	Solenoid, Low Clutch Timing (Gray Connector).....	1	99-Up	23432C	N/A
433	Solenoid, Transfer Clutch Duty (2.160" Tall Body) .....	1	87-E95	23433	5A-181
433	Solenoid, Transfer Clutch Duty (2.460" Tall Body) .....	1	L95-98	23433B	5A-181A
433	Solenoid, Transfer Clutch Duty & VB (back side of main case) .....	1	99-Up	23433A	5A-181B
<b>HARD PARTS</b>					
Prefix Key: D = OEM, A = Aftermarket New, R = Remanufactured					
<b>DRUMS</b>					
555B	Forward Drum & Sprag Update) (Replaces 34 Element Sprag) .....	1	87-Up	73554A	78925
555B	High (30 T Reverse Hub).....	1	87-Up	73555A	78922B
555B	High (34 T Reverse Hub).....	1	87-Up	93555	68925
556E	Reverse .....	1	87-Up	73556	78921

