

# TH180(MD3) 3L30 TH180C(MD2) w/L/U

# 4L30E (ML4) 4 SPEED ELECTRONIC - 1990-UP

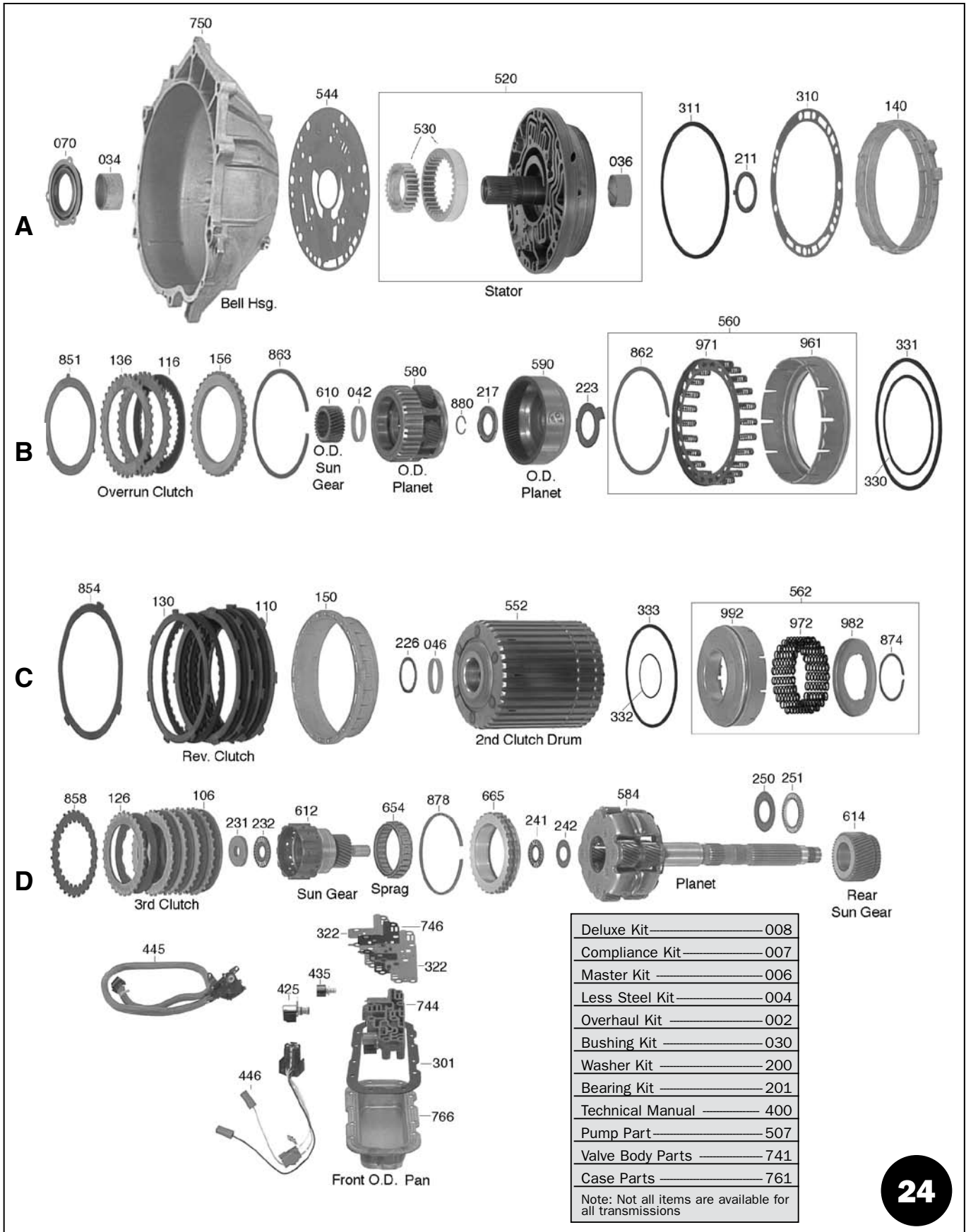

# TH180(MD3) 3L30 TH180C(MD2) w/L/U

# 4L30E (ML4) 4 SPEED ELECTRONIC - 1990-UP

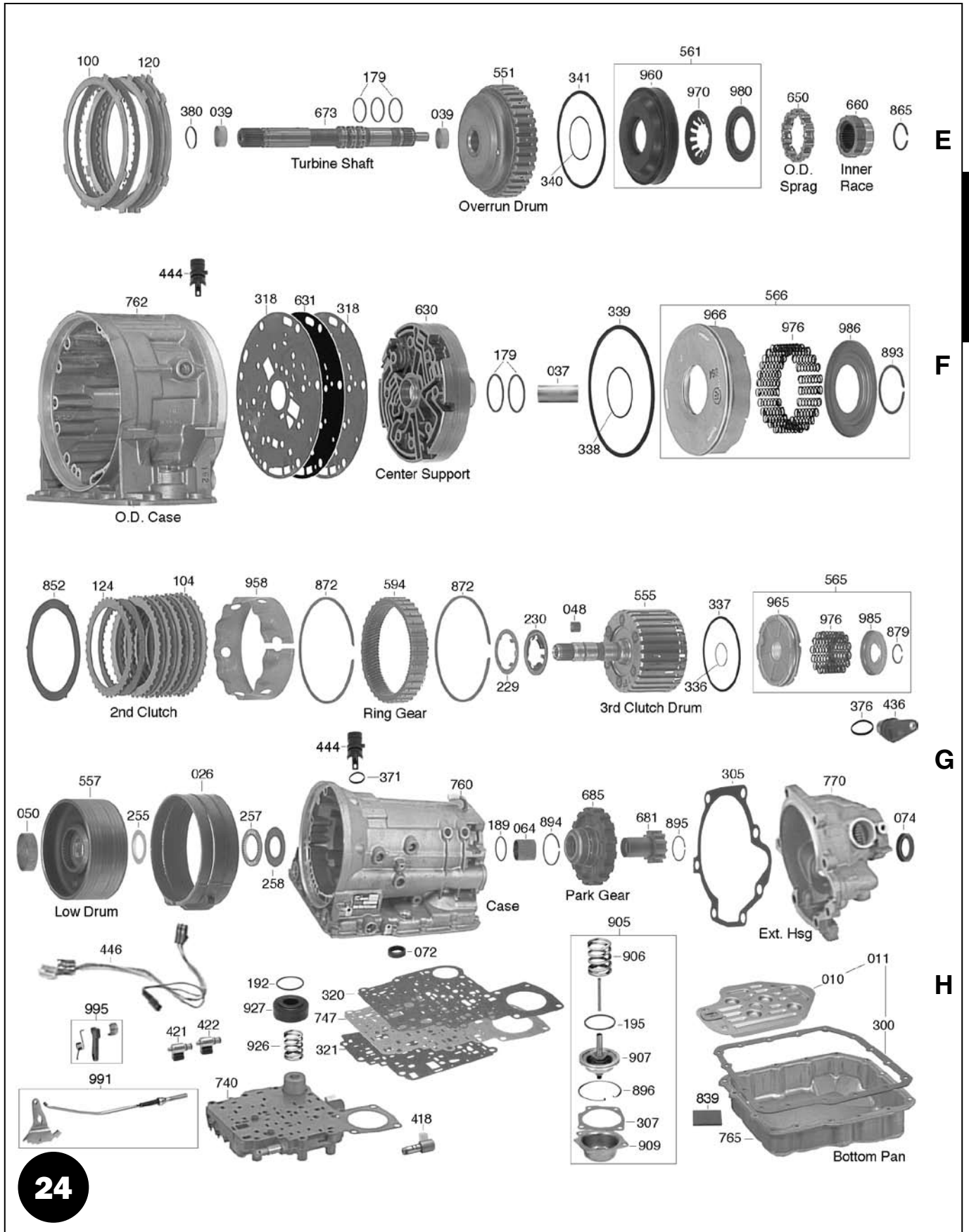

# 4L30E (ML4) 4 SPEED ELECTRONIC - 1990-UP

# TH180(MD3) 3L30 TH180C(MD2) w/L/U



24010



24010E



24010E

### 3L30 - 3 SPEED - 69-Up

Buick Opel	77-87
Chevette	77-87
GEO Tracker	90-Up
Pontiac T-1000	77-87
Jaguar XJS, XJ12	80-92
Holden - Australia	
Ranger - S. Africa	
<b>Post Office Vehicles LLV - 87-Up</b>	
Alpine	
Fiat	Some
77-82	
Peugeot 604	77-87
Straussburg - Germany	
Vauzhaul - Many	
Zimmer Motor Home	
Suzuki Sidekick	

### 4L30E - 4 SPEED - 90-Up

Cadillac Catera 3.0L	
Isuzu Amigo	
Impulse	
Pickups, Rodeo	91-98
Trooper	90-98
Trooper II	
BMW 325i, 318i, 323i, 328i,	
525i, 528i, Z3 Roadster	91-Up
Honda Passport	94-Up
Acura SLX	98-98

**NOTE:** Some Isuzu models (88-90) use Toyota A43 Series

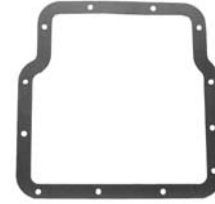

24300

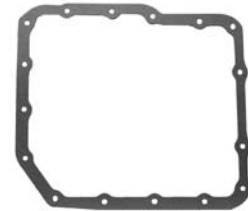

24300AF

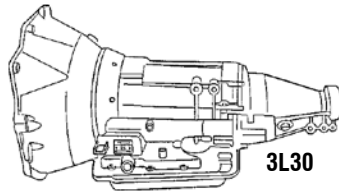

3L30

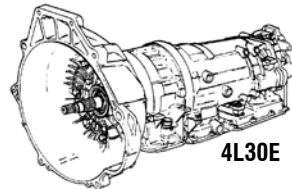

4L30E

ILL.	DESCRIPTION	QTY.	YEAR	PART NO.	REFERENCE NO.
<b>DELUXE KITS (SUPER KITS)</b>					
008D	180,180C (1).....	1	69-Up	24008F	K4100-R
008D	4L30E (w/ .098" 3rd Clutch Friction) (Exc 95-97 BMW).....	1	90-97	24008EF	K4100E-R
008D	4L30E (w/ .063" 3rd Clutch Friction) (Incl 95-97 BMW).....	1	98-Up	24008EAF	K4100F-R
<b>COMPLIANCE KITS (CALIFORNIA KITS)</b>					
007D	180,180C (1).....	1	69-Up	24007F	CK4100-R
007D	4L30E (w/ .098" 3rd Clutch Friction) (Exc 95-97 BMW).....	1	90-97	24007EF	CK4100E-R
007D	4L30E (w/ .063" 3rd Clutch Friction) (Incl 95-97 BMW).....	1	98-Up	24007EAF	CK4100F-R
<b>MASTER OVERHAUL KITS (WITH STEELS)</b>					
006D	180,180C (1).....	1	69-Up	24006F	K4100
006D	4L30E (w/ .098" 3rd Clutch Friction) (Exc 95-97 BMW).....	1	90-97	24006EF	K4100E
006D	4L30E (w/ .063" 3rd Clutch Friction) (Incl 95-97 BMW).....	1	98-Up	24006EAF	K4100F
<b>LESS STEEL KITS</b>					
004D	180,180C (1).....	1	69-Up	24004F	K4100-LS
004D	4L30E (w/ .098" 3rd Clutch Friction) (Exc 95-97 BMW).....	1	90-97	24004EF	K4100E-LS
004D	4L30E (w/ .063" 3rd Clutch Friction) (Incl 95-97 BMW).....	1	98-Up	24004EAF	K4100F-LS
<b>OVERHAUL KITS (W/ RINGS &amp; SEALS)</b>					
002D	180,180C (1).....	1	69-Up	24002F	K41900
002D	4L30E.....	1	90-Up	24002EF	K41900E
<b>GASKET &amp; SEAL KITS (W/O RINGS &amp; SEALS)</b>					
000D	180,180C (1)..... <i>(1) 180, 180C Kits do not include Tracker/Sidekick 2wd Ext Hsg Seal, # 24074A.</i>	1	69-Up	24000F	K41900-1
<b>FILTER KITS</b>					
011H	Filter Kit (180,180C).....	1	69-Up	24011	FK41800
011H	Filter Kit (4L30E) (Exc BMW).....	1	90-Up	24011E	FK41800E
011H	Filter Kit (4L30E) (BMW).....	1	91-Up	24011EA	FK41800F

# TH180(MD3) 3L30 TH180C(MD2) w/L/U

# 4L30E (ML4) 4 SPEED ELECTRONIC - 1990-UP

ILL.	DESCRIPTION	QTY.	YEAR	PART NO.	REFERENCE NO.
<b>FILTERS</b>					
010H	Filter (180,180C).....	1	69-Up	24010	41800
010H	Filter (4L30E) (Exc BMW).....	1	90-Up	24010E	41800E
010H	Filter (4L30E) (BMW).....	1	91-Up	24010EA	41800F
015	Screen, PWM Solenoid (3 3/4" Long In Valve Body) (4L30E).....	1	90-Up	24015	41712
018	Screen, Force Motor (In Auxiliary Valve Body) (4L30E).....	1	90-Up	24018	41712A
<b>BANDS</b>					
Prefix Key: B = Borg Warner, A = OEM (Exc BW), N = All Other New, R = Relined					
026H	Low (All).....	1	69-Up	24026	41700
<b>BUSHINGS</b>					
030D	Bushing Kit (180,180C).....	1	69-Up	24030	K41901
030D	Bushing Kit (4L30E) (may not incl. Center Support Bushing).....	1	90-Up	24030B	K41901A
034A	Pump (Narrow).....	1	69-Up	24034A	41005
034A	Pump (Tighter Tolerance) (Machining Needed).....	1	69-Up	24034	54253-01
034A	Pump (Wide) (Use caution not to cover or block the oil lube hole) (All).....	1	69-Up	44034	8005
036A	Stator Support (All).....	1	69-Up	24036	41003
036A	Stator Support (All) (Bronze).....	1	69-Up	24036X	41003X
044	Center Support (4L30E).....	1	90-Up	24044	41003A
044	Center Support (4L30E) (Bronze).....	1	90-Up	24044X	41003AX
046C	2nd Clutch Drum (All).....	1	69-Up	24046	41000
050H	Input Sun Gear (All).....	1	69-Up	24050	41009
064H	Case (All).....	1	69-Up	24064	41012
064H	Case (No Walk) (All).....	1	69-Up	24064B	41012X
066	Extension Housing (Exc 90-Up Tracker) 1.630"OD, .940" Tall.....	1	69-Up	44066B	8008
066	Extension Housing (90-Up Tracker) 1.538"OD, 1.455" Tall.....	1	69-Up	24066C	N/A
<b>METAL CLAD SEALS</b>					
070A	Front (180, 180C).....	1	69-Up	24070	41151
070A	Front (4L30E).....	1	90-Up	24070A	41151E
074H	Rear (Some) (180, 180C).....	1	69-Up	44074	8850B
074H	Rear (Sidekick 2wd, Tracker 2wd) (180, 180C).....	1	92-Up	24074A	41201A
074H	Rear (Sidekick 4wd, Tracker 4wd) (180, 180C).....	1	92-Up	67076A	75201M
07H	Rear (4L30E).....	1	90-Up	69074	56201B
072H	Linkage Shaft (4L30E).....	1	90-Up	84072A	51202A
<b>FRICITION PLATES</b>					
100E	4th Clutch (4L30E).....	3	90-Up	24100	41106
104G	2nd Clutch.....	3-6	69-Up	24104	41102
106D	3rd Clutch (.063").....	2-5	95-Up	24106A	41104A
106D	3rd Clutch (.100").....	2-5	69-Up	24106	41104
110C	Reverse.....	2-5	69-Up	24110	41100
116B	Overrun (4L30E).....	2	90-Up	24116	41108
<b>STEEL PLATES</b>					
120E	4th Clutch (4L30E).....	4	90-Up	24120	41107
124G	2nd Clutch (.070").....	3-7	69-Up	24124A	41103
124G	2nd Clutch (.083").....	3-7	69-Up	24124	41103A
126D	3rd Clutch (.070").....	3-6	69-Up	24126A	41105
126D	3rd Clutch (.083").....	3-6	69-Up	24126	41105A
130C	Reverse (.070").....	3-5	69-Up	24130	41101
130C	Reverse (.083").....	3-6	69-Up	24130A	41101A
136B	Overrun (4L30E).....	2	90-Up	24136	41109
N.I.	Steel Module.....	1	90-Up	24139E	N/A

TH180/4L30E

# 4L30E (ML4) 4 SPEED ELECTRONIC - 1990-UP

# TH180(MD3) 3L30 TH180C(MD2) w/L/U

ILL.	DESCRIPTION	QTY.	YEAR	PART NO.	REFERENCE NO.
<b>MODULATORS</b>					
160	Green Stripe (Non Adjustable) (180, 180C).....	1	69-Up	24160	41820X
160	Blue Stripe (Non Adjustable) (180, 180C).....	1	69-Up	24160B	N/A
160	Dual Green Stripe (Adjustable) (Post Office Vehicles) (180, 180C) .....	1	69-Up	24160C	41820B
160	Dual Blue Stripe (Adjustable) (Chevrolet) (180, 180C).....	1	69-Up	24160E	41820A
160	Purple Stripe (Adjustable) (GEO Tracker, Suzuki) (180, 180C).....	1	89-Up	24160G	N/A
<b>VALVE BODY RECALIBRATION KITS</b>					
165D	Shift Kit® (180C) (Transgo®).....	1	82-Up	T24165	K41908
165D	Shift Kit® (4L30E) (BMW, Volvo, Cadillac) (Transgo®).....	1	91-04	T24165E	N/A
165D	Shift Correction Package (4L30E) (Superior) .....	1	90-Up	S24165E	41C03
165D	Valve Body Kit (4L30E) (Trans Lab) .....	1	90-Up	A24165E	41D02
<b>SEALING RINGS</b>					
175D	Ring Kit (180, 180C Exc Holden) .....	1	69-Up	24175	K41300
175D	Ring Kit (4L30E) .....	1	90-Up	24175E	K41300E
<b>THRUST WASHERS</b>					
200D	Pump Washer Kit (All) .....	1	69-Up	24200B	K41208
211A	Pump Washer & Shim Kit (All).....	1	69-Up	24211K	K41208D
211A	Pump .059" (Yellow) (3 Tabs) (All).....	1	69-Up	24211B	41208
	067" Red=BA, .075" Black=BB, .082" White=BC, .090" Green=BD, .098" Blue=BE				
223B	Overdrive Ring Gear to Overdrive Case (2 Tab) (4L30E) .....	1	90-Up	54223B	32420
226C	Center Support Selective .063" (Yellow) (4L30E) .....	1	90-Up	24226A	N/A
	.070" Red=B, .077" Black=C, .085" White=D, .092" Green=E, .099"=Blue=F.....				
229G	2nd Drum to 3rd Drum (Front) (3 Tab Metal) (All) .....	1	69-Up	24229	41210
229G	2nd Drum to 3rd Drum (Front) (Plastic) (All).....	1	69-Up	24229A	N/A
230G	2nd Drum to 3rd Drum (Rear) (All) .....	1	69-Up	24230	N/A
<b>GASKETS &amp; O-RINGS</b>					
300H	Gasket, Pan (Cork) (180, 180C) .....	1	69-Up	24300	13600X
300H	Gasket, Pan (Fiber) (180, 180C).....	1	69-Up	24300F	13600F
300H	Gasket, Pan (Exc BMW) (Cork) (4L30E) .....	1	90-Up	24300A	N/A
300H	Gasket, Pan (Exc BMW) (Fiber) (4L30E) .....	1	90-Up	24300AF	13600AF
300H	Gasket, Pan (BMW) (Cork) (4L30E).....	1	90-Up	24300B	N/A
300H	Gasket, Pan (BMW) (Fiber) (4L30E) .....	1	90-Up	24300BF	13600BF
301D	Gasket, Front Overdrive Pan (Cork) (4L30E).....	1	90-Up	24301A	13605F
301D	Gasket, Front Overdrive Pan (Fiber) (4L30E) .....	1	90-Up	24301AF	N/A
305H	Gasket, Extension Housing (180, 180C) .....	1	69-Up	24305	13927
305H	Gasket, Extension Housing (4L30E).....	1	90-Up	24305E	13927B
310A	Gasket, Pump (180, 180C).....	1	69-Up	24310	13601
310A	Gasket, Pump (4L30E).....	1	90-Up	24310E	13601B
310A	O-Ring, Pump & Overdrive Housing (All) .....	1	69-Up	24311	13602
310A	O-Ring, Overdrive Housing (4L30E).....	1	69-Up	24311	13602
320H	Gasket, Upper Valve Body (4L30E).....	1	90-Up	24320B	K13616E
321H	Gasket, Lower Valve Body (4L30E).....	1	90-Up	24321B	K13616E
<b>TECHNICAL MANUALS</b>					
400D	Tech Manual (180C).....	1	69-Up	24400	N/A
400D	Tech Manual (4L30E) .....	1	90-Up	24400E	41Y02
400D	Transmission Guide (GM) (4L30E) .....	1	90-Up	24400EA	N/A
<b>ELECTRICAL COMPONENTS</b>					
418H	Solenoid, PWM (Low Band Control) .....	1	90-Up	24418	5A-162
421H	Solenoid, 1-2 & 3-4 Shift .....	1	90-Up	24421E	5A-154
422H	Solenoid, 2-3 Shift .....	1	90-Up	24422E	5A-155

# TH180(MD3) 3L30 TH180C(MD2) w/L/U

# 4L30E (ML4) 4 SPEED ELECTRONIC - 1990-UP

TH180/4L30E

ILL.	DESCRIPTION	QTY.	YEAR	PART NO.	REFERENCE NO.
<b>ELECTRICAL COMPONENTS (Cont.)</b>					
425D	Solenoid, TCC Lock-Up (180C).....	1	82-Up	D24425B	5A-165
425D	Solenoid, TCC Lock-Up (180C) (Rostra) .....	1	82-Up	24425B	5R-165
425D	Solenoid, TCC Lock-Up (4L30E).....	1	90-99	24425E	5A-159
425D	Solenoid, TCC Lock-Up (4L30E).....	1	00-Up	34418	5A-151
435D	Solenoid, EPC (Holley) (w/ 2 Gray Screens, 2 Bottom Prongs) .....	1	90-99	34435A	5D-152A
435D	Solenoid, EPC (Bosch) (w/ 2 White Screens, 2 Bottom Prongs) .....	1	90-99	34435	5D-152
435D	Solenoid, EPC (Bosch) (w/ 2 Red Screens, 2 Side Prongs) .....	1	00-Up	56431A	5A-451B
436	Speed Sensor, Output (VSS) (Exc BMW).....	1	90-Up	24436	N/A
444H	Connector, Case (3 Prong) .....	1	80-Up	74444A	25A-103
444H	Connector, Case (Square 4 Prong) (6 Cyl 90-99) (4 Cyl 90-01) .....	1	90-01	84444	25A-104
444H	Connector, Case (Round 7 Prong) (6 Cyl 00-Up) (4 Cyl 02-Up).....	1	00-Up	24444E	25A-116C
444H	Connector, Overdrive Housing (5 Prong) (6 Cyl 90-99) (4 Cyl 90-01).....	1	90-01	24444F	25A-116B
444H	Connector, Overdrive Housing (4 Prong) (6 Cyl 00-Up) (4 Cyl 02-Up) .....	1	00-Up	84444	25A-104
446D	Internal Wire Harness, Case (4 Prong) (Exc BMW) (6 Cyl 90-99) (4 Cyl 90-01) .....	1	90-99	24446E	35A-116
446D	Internal Wire Harness, Case (6 Prong) (Exc BMW) (6 Cyl 00-Up) (4 Cyl 02-Up).....	1	00-Up	24446EA	35A-116D
446D	Internal Wire Harness, Case (BMW).....	1	91-Up	24446EE	35A-116B
446D	Internal Wire Harness, OD Hsg (5 Prong) (6 Cyl 90-99) (4 Cyl 90-01) .....	1	90-01	24446EB	35A-116A
446D	Internal Wire Harness, OD Hsg (4 Prong Orange Wire) (6 Cyl 00-Up) (4 Cyl 02-Up) ...	1	00-Up	24446EC	35A-116C
446D	Internal Wire Harness, OD Hsg (4 Prong Blue Wire w/ Push-in TCC) .....	1	00-Up	24446ED	35A-116F
<b>HARD PARTS</b>					
Prefix Key: D = OEM, A = Aftermarket New, R = Remanufactured					
<b>PUMPS &amp; COMPONENTS</b>					
520A	Stator w/ Gears (.515" OD Pressure Regulator) (4L30E) .....	1	90-Up	24520E	N/A
520A	Stator w/ Gears (.595" OD Pressure Regulator) (4L30E) .....	1	90-Up	24520EA	41424E
520A	Stator w/ Gears (4 Valve Type) (4L30E) .....	1	00-Up	24520EA	N/A
530A	Pump Gears (All .628") .....	1	69-Up	24530A	K41201
544A	Plate, Pump (180C) .....	1	82-Up	24544C	41202A
544A	Plate, Pump (4L30E).....	1	90-Up	24544E	N/A
507D	Boost Valve, Pump (Small Ratio Stamped 066) (4L30E) .....	1	90-Up	24507FB	K41971C
507D	Boost Valve, Pump (Small Ratio Stamped 067) (4L30E) .....	1	90-Up	24507FC	K41971B
507D	Boost Valve, Pump (Medium Ratio) (4L30E) .....	1	90-Up	24507F	K41971A
507D	Boost Valve, Pump (Large Ratio) (4L30E).....	1	90-Up	24507FA	K41971
507D	Valve & Sleeve, TCC Reg.....	1	90-Up	24507	K41856
<b>DRUMS &amp; HUBS</b>					
551E	Overrun Clutch (2 Clutch) (4L30E) .....	1	90-Up	24551	41948
552C	2nd Clutch (All 79-Up) .....	1	79-Up	24552A	41254
555G	3rd Clutch Drum w/ Shaft (w/ 3 1/2" Long Shaft) (4L30E).....	1	90-Up	24555E	41961E
557H	Low Band (Less Rear Sun Gear) (4L30E) .....	1	90-Up	24557E	N/A
<b>PLANETS</b>					
580B	Overdrive Planet (31 T Sun Gear) (4L30E) .....	1	90-Up	24580	41950
583	Planet Package, 3 Gear (3L30) (LLV) (Replaces Coarse or Fine Pitch).....	1	87-Up	24583	K41907A/B
583	Planet Package, 4 Gear (4L30E) (GM) (Slip Yoke) (2) .....	1	90-Up	24583FB	K41907H
583	Planet Package, 4 Gear (4L30E) (BMW) (Bolt Yoke, .550" Dia Pilot) (2) .....	1	90-Up	24583F	K41907G
583	Planet Package, 4 Gear (4L30E) (BMW) (Bolt Yoke, .640" Dia Pilot) (2) .....	1	90-Up	24583FA	K41907J
583	Planet Package, 4 Gear (4L30E) (Isuzu) (2wd) (2).....	1	90-Up	24583EA	K41907D
583	Planet Package, 4 Gear (4L30E) (Isuzu) (4wd) (2).....	1	90-Up	24583E	K41907F
583	Planet Package, 4 Gear (4L30E) (Passport) (4wd) (2) .....	1	90-Up	24583AA	K41907
590B	Ring Gear, Overdrive Planet (31 T Sun Gear # 610) (4L30E) .....	1	90-Up	24590	N/A
594G	Ring Gear, Planet (30 T Sun Gear # 612) (4L30E).....	1	90-Up	24594E	N/A
<b>(2) 4L30E Packages include 48 T Input, 46 T Reaction Sun Gear, Ring Gear &amp; Planet</b>					

**4L30E (ML4) 4 SPEED  
ELECTRONIC - 1990-UP**

**TH180(MD3) 3L30  
TH180C(MD2) w/L/U**

ILL.	DESCRIPTION	QTY.	YEAR	PART NO.	REFERENCE NO.
<b>SUN GEARS, SHELLS &amp; SUPPORTS</b>					
610B	Sun Gear, Overdrive Planet (31 T) (4L30E) .....	1	90-Up	24610	41952
612D	Sun Gear, w/ Inner Race (25 T) (180, 180C).....	1	69-86	24612	N/A
612D	Sun Gear, w/ Inner Race (30 T) (All) .....	1	87-Up	24612E	N/A
614D	Sun Gear, Rear (46 Teeth, Separate From Low Drum) (4L30E) .....	1	90-Up	24614E	N/A
630F	Center Support (Cast # 069 DD2) (4L30E) .....	1	90-Up	24630	N/A
630F	Center Support (Cast # 513 FU2) (w/ 2 Valves Inside) (4L30E).....	1	90-Up	24630B	41902
631F	Plate, Overdrive Case to Center Support (4L30E).....	1	90-Up	24631	N/A
<b>SPRAGS</b>					
650E	Sprag, Overdrive (4L30E) .....	1	90-Up	54650B	32849
654D	Sprag, 3rd Clutch (16 Elements) (All) .....	1	69-Up	24654	N/A
654D	Sprag, 3rd Clutch (26 Elements) (All) .....	1	69-Up	74658	61725
<b>SHAFTS</b>					
673E	Turbine Shaft (w/ Check Ball Capsule) (4L30E).....	1	90-Up	24673	N/A
673E	Turbine Shaft (w/o Check Ball Capsule) (4L30E).....	1	90-Up	24673A	N/A
<b>VALVE BODIES</b>					
740H	Valve Body (w/ 3 Solenoid) (4L30E) .....	1	90-Up	24740E	N/A
<b>CASES &amp; HOUSINGS</b>					
765H	Pan, Bottom Rear (4L30E).....	1	90-Up	24765E	N/A
765H	Pan, Bottom Rear (3.560" Deep) (4L30E).....	1	90-Up	24765EB	N/A
<b>MISCELLANEOUS COMPONENTS</b>					
939	Cover, Overdrive Accumulator (Molded Rubber) (4L30E) .....	1	95-Up	24939	41530
960E	Piston, Overrun Clutch (Molded Rubber) (4L30E) .....	1	90-Up	24960	41528N
970E	Spring, Overrun Clutch Return (4L30E).....	1	90-Up	24970	N/A
Tool	Converter Housing To Front Pump Alignment Tool.....	1	69-81	T-1080	T-1080
Tool	Converter Housing To Front Pump Alignment Tool (Pontiac).....	1	82-Up	T-1080-A	T-1080-A
Tool	Pump Alignment Tool (4L30E) .....	1	90-Up	T-1080-B	T-1080-B
Tool	Third Clutch Ring Compressor - Late 79-Up .....	1	79-Up	T-1085-A	T-1085-A
Tool	Governor Bore Case Sleeve Tool.....	1	69-Up	T-1195	T-1195
Tool	Governor Bore Case Sleeve .....	1	69-Up	T-1195-SL	T-1195-SL
<b>NOTES</b>					